

# **NORDIC OVERNIGHTER**



Disclaimer: © 2022 Tiny Easy LTD - This Document was automatically generated using the 3D Tiny House Designer by Tiny Easy LTD and all copyright belongs to Tiny Easy LTD. Content made available on [www.tinyeasy.co.nz](http://www.tinyeasy.co.nz) is for general information purposes only. Although all Materials have been created by a team of knowledgeable design experts and regularly undergo reviews and updates, Materials are created for a large range of users from many different countries that all have different laws and requirements for tiny homes. Accordingly, the information contained in the Materials does not constitute architectural advice, nor are they a substitute for architectural advice. Furthermore, any assistance and customer support provided by us does not establish an architect-client relationship. Tiny Easy cannot guarantee the Materials will be compliant with any applicable law in your jurisdiction. Our Materials are intended to provide ideas and inspiration, but you cannot rely on the Materials for your tiny home project you must seek advice from engineers, licensed building practitioners, and/or architects in your country. Before purchasing any Materials it is your sole responsibility to determine the legal requirements and restrictions attached to tiny homes in your country and any compliance issues that you might encounter.

Name: Nordic Overnighter

Scale: 1:50 (At A4)

System: Imperial (fr)

Plan: Front Left Isometric

1



Disclaimer: © 2022 Tiny Easy LTD - This Document was automatically generated using the 3D Tiny House Designer by Tiny Easy LTD and all copyright belongs to Tiny Easy LTD. Content made available on [www.tinyeasy.co.nz](http://www.tinyeasy.co.nz) is for general information purposes only. Although all Materials have been created by a team of knowledgeable design experts and regularly undergo reviews and updates, Materials are created for a large range of users from many different countries that all have different laws and requirements for tiny homes. Accordingly, the information contained in the Materials does not constitute architectural advice, nor are they a substitute for architectural advice. Furthermore, any assistance and customer support provided by us does not establish an architect-client relationship. Tiny Easy cannot guarantee the Materials will be compliant with any applicable law in your jurisdiction. Our Materials are intended to provide ideas and inspiration, but you cannot rely on the Materials for your tiny home project you must seek advice from engineers, licensed building practitioners, and/or architects in your country. Before purchasing any Materials it is your sole responsibility to determine the legal requirements and restrictions attached to tiny homes in your country and any compliance issues that you might encounter.

Name: Nordic Overnighter

Scale: 1:50 (At A4)

System: Imperial (fr)

Plan: Rear Right Isometric

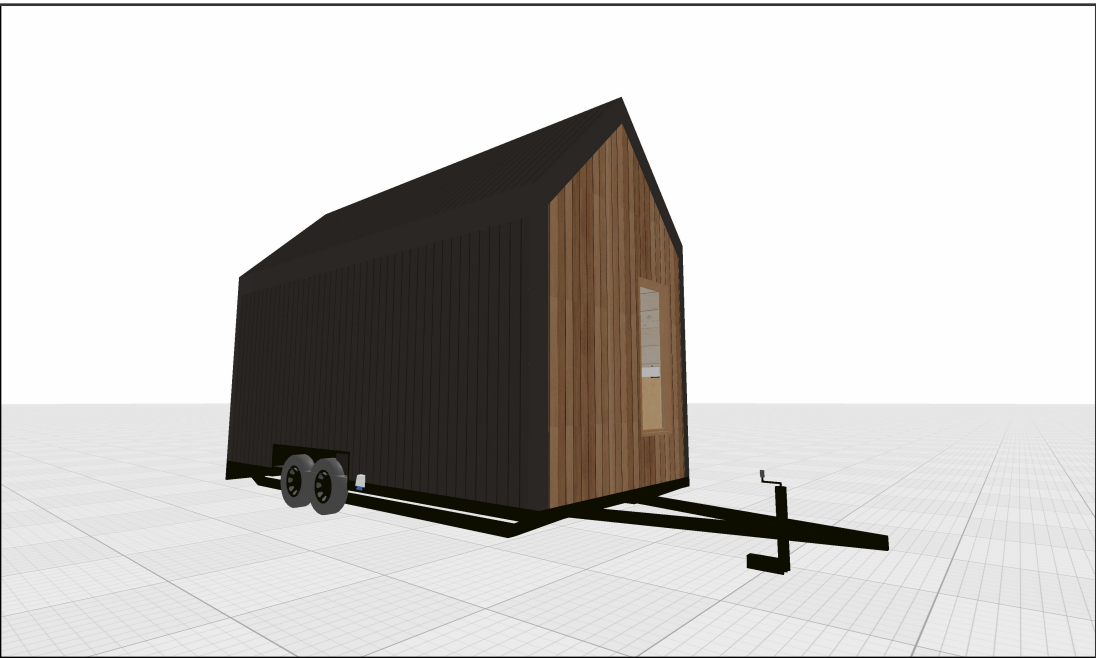

Disclaimer: © 2022 Tiny Easy LTD - This Document was automatically generated using the 3D Tiny House Designer by Tiny Easy LTD and all copyright belongs to Tiny Easy LTD. Content made available on [www.tinyeasy.co.nz](http://www.tinyeasy.co.nz) is for general information purposes only. Although all Materials have been created by a team of knowledgeable design experts and regularly undergo reviews and updates, Materials are created for a large range of users from many different countries that all have different laws and requirements for tiny homes. Accordingly, the information contained in the Materials does not constitute architectural advice, nor are they a substitute for architectural advice. Furthermore, any assistance and customer support provided by us does not establish an architect-client relationship. Tiny Easy cannot guarantee the Materials will be compliant with any applicable law in your jurisdiction. Our Materials are intended to provide ideas and inspiration, but you cannot rely on the Materials for your tiny home project you must seek advice from engineers, licensed building practitioners, and/or architects in your country. Before purchasing any Materials it is your sole responsibility to determine the legal requirements and restrictions attached to tiny homes in your country and any compliance issues that you might encounter.

Name: Nordic Overnighter  
Scale: 1:- (At A4)  
System: Imperial (fr)  
Plan: Exterior Perspectives

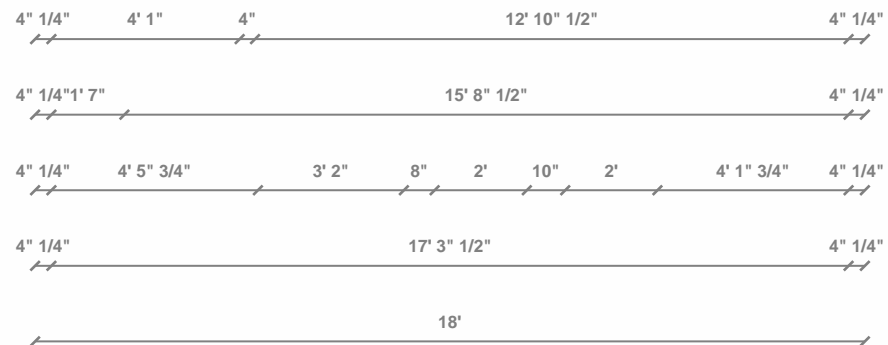
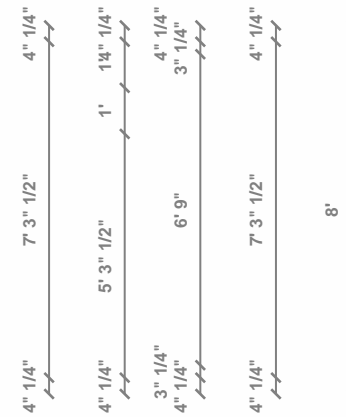
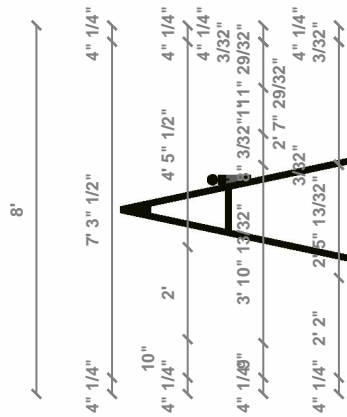
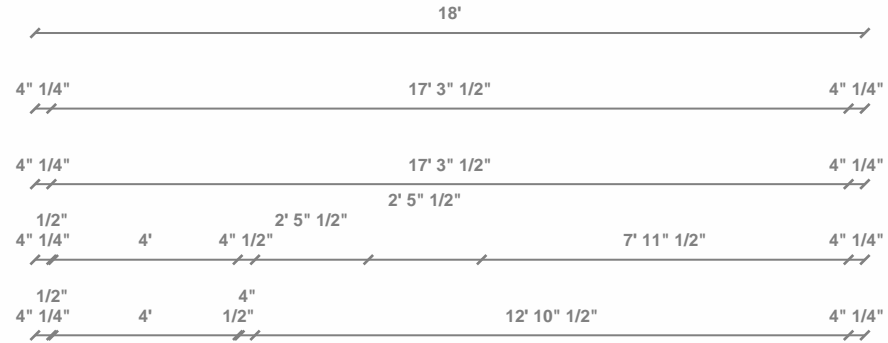

Disclaimer: © 2022 Tiny Easy LTD - This Document was automatically generated using the 3D Tiny House Designer by Tiny Easy LTD and all copyright belongs to Tiny Easy LTD. Content made available on [www.tinyeasy.co.nz](http://www.tinyeasy.co.nz) is for general information purposes only. Although all Materials have been created by a team of knowledgeable design experts and regularly undergo reviews and updates, Materials are created for a large range of users from many different countries that all have different laws and requirements for tiny homes. Accordingly, the information contained in the Materials does not constitute architectural advice, nor are they a substitute for architectural advice. Furthermore, any assistance and customer support provided by us does not establish an architect-client relationship. Tiny Easy cannot guarantee the Materials will be compliant with any applicable law in your jurisdiction. Our Materials are intended to provide ideas and inspiration, but you cannot rely on the Materials for your tiny home project you must seek advice from engineers, licensed building practitioners, and/or architects in your country. Before purchasing any Materials it is your sole responsibility to determine the legal requirements and restrictions attached to tiny homes in your country and any compliance issues that you might encounter.

Name: Nordic Overnighter

Scale: 1:50 (At A4)

System: Imperial (fr)

Plan: Floor Plan

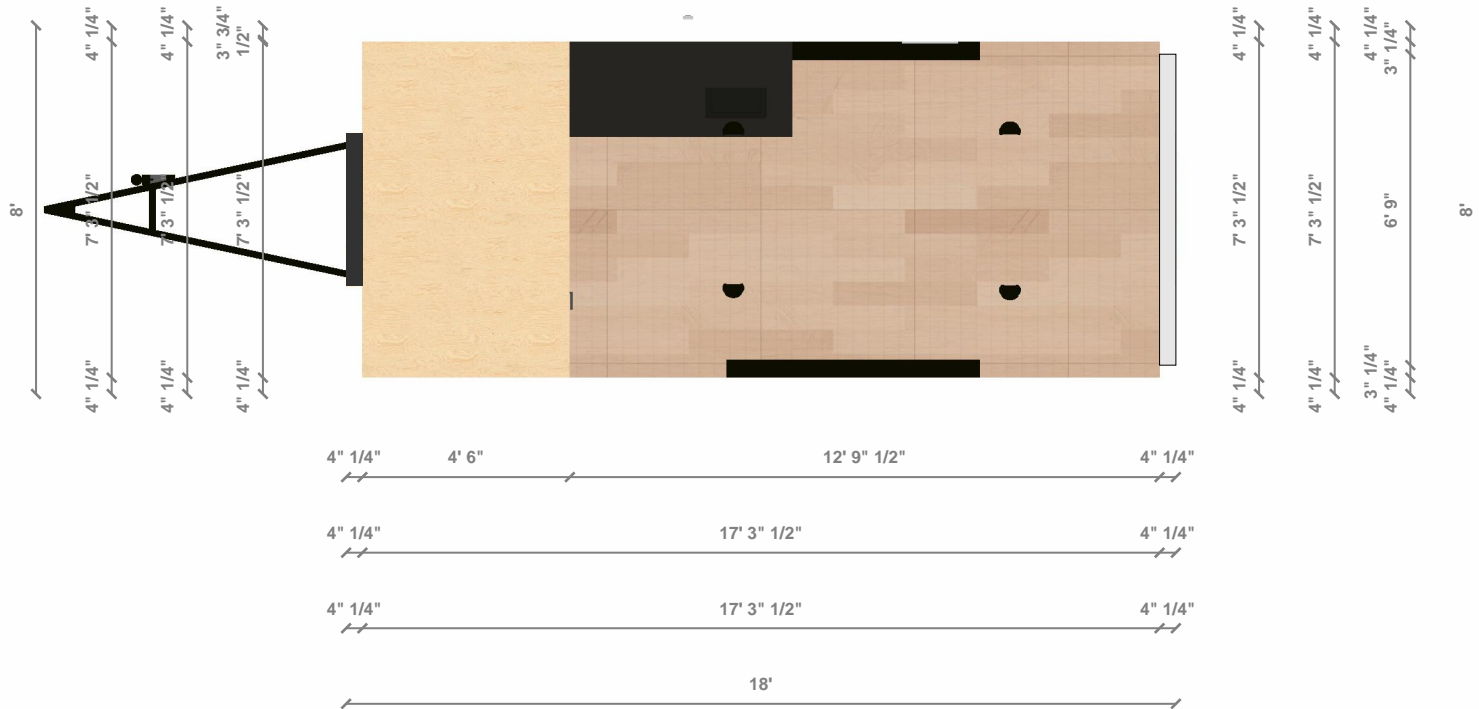
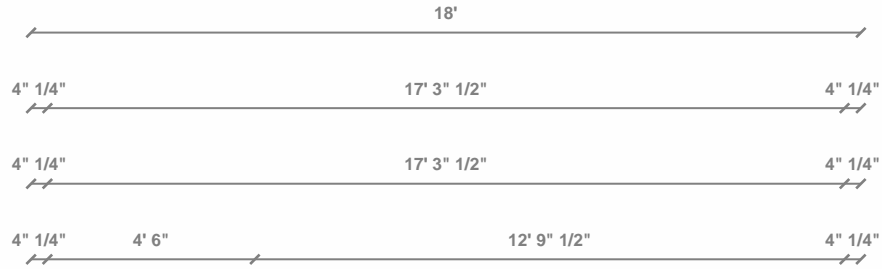

Disclaimer: © 2022 Tiny Easy LTD - This Document was automatically generated using the 3D Tiny House Designer by Tiny Easy LTD and all copyright belongs to Tiny Easy LTD. Content made available on [www.tinyeasy.co.nz](http://www.tinyeasy.co.nz) is for general information purposes only. Although all Materials have been created by a team of knowledgeable design experts and regularly undergo reviews and updates, Materials are created for a large range of users from many different countries that all have different laws and requirements for tiny homes. Accordingly, the information contained in the Materials does not constitute architectural advice, nor are they a substitute for architectural advice. Furthermore, any assistance and customer support provided by us does not establish an architect-client relationship. Tiny Easy cannot guarantee the Materials will be compliant with any applicable law in your jurisdiction. Our Materials are intended to provide ideas and inspiration, but you cannot rely on the Materials for your tiny home project you must seek advice from engineers, licensed building practitioners, and/or architects in your country. Before purchasing any Materials it is your sole responsibility to determine the legal requirements and restrictions attached to tiny homes in your country and any compliance issues that you might encounter.

Name: Nordic Overnighter

Scale: 1:50 (At A4)

System: Imperial (fr)

Plan: Mezzanine Plan

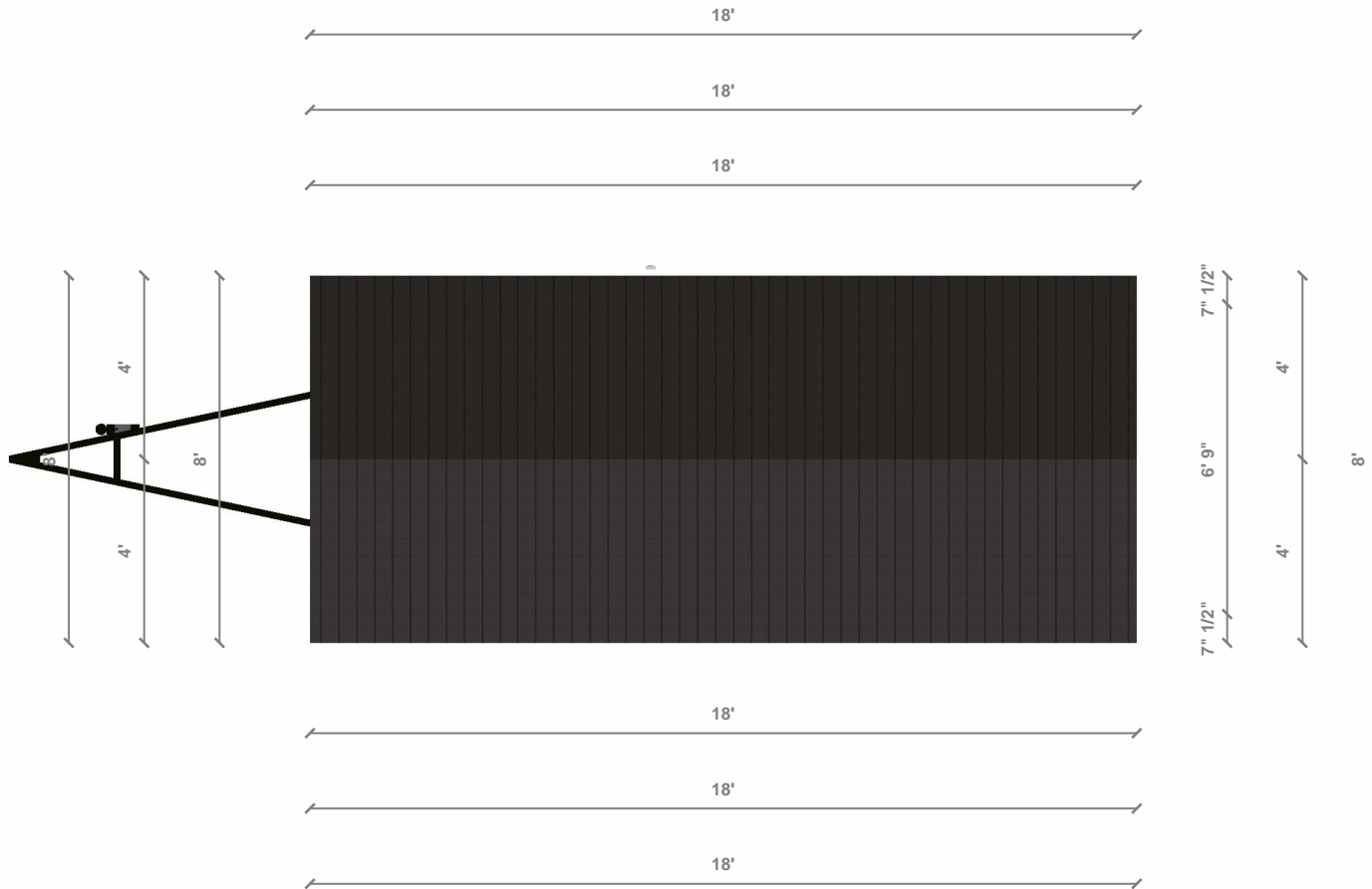

Disclaimer: © 2022 Tiny Easy LTD - This Document was automatically generated using the 3D Tiny House Designer by Tiny Easy LTD and all copyright belongs to Tiny Easy LTD. Content made available on [www.tinyeasy.co.nz](http://www.tinyeasy.co.nz) is for general information purposes only. Although all Materials have been created by a team of knowledgeable design experts and regularly undergo reviews and updates, Materials are created for a large range of users from many different countries that all have different laws and requirements for tiny homes. Accordingly, the information contained in the Materials does not constitute architectural advice, nor are they a substitute for architectural advice. Furthermore, any assistance and customer support provided by us does not establish an architect-client relationship. Tiny Easy cannot guarantee the Materials will be compliant with any applicable law in your jurisdiction. Our Materials are intended to provide ideas and inspiration, but you cannot rely on the Materials for your tiny home project you must seek advice from engineers, licensed building practitioners, and/or architects in your country. Before purchasing any Materials it is your sole responsibility to determine the legal requirements and restrictions attached to tiny homes in your country and any compliance issues that you might encounter.

Name: Nordic Overnighter

Scale: 1:50 (At A4)

System: Imperial (fr)

Plan: Roof Plan

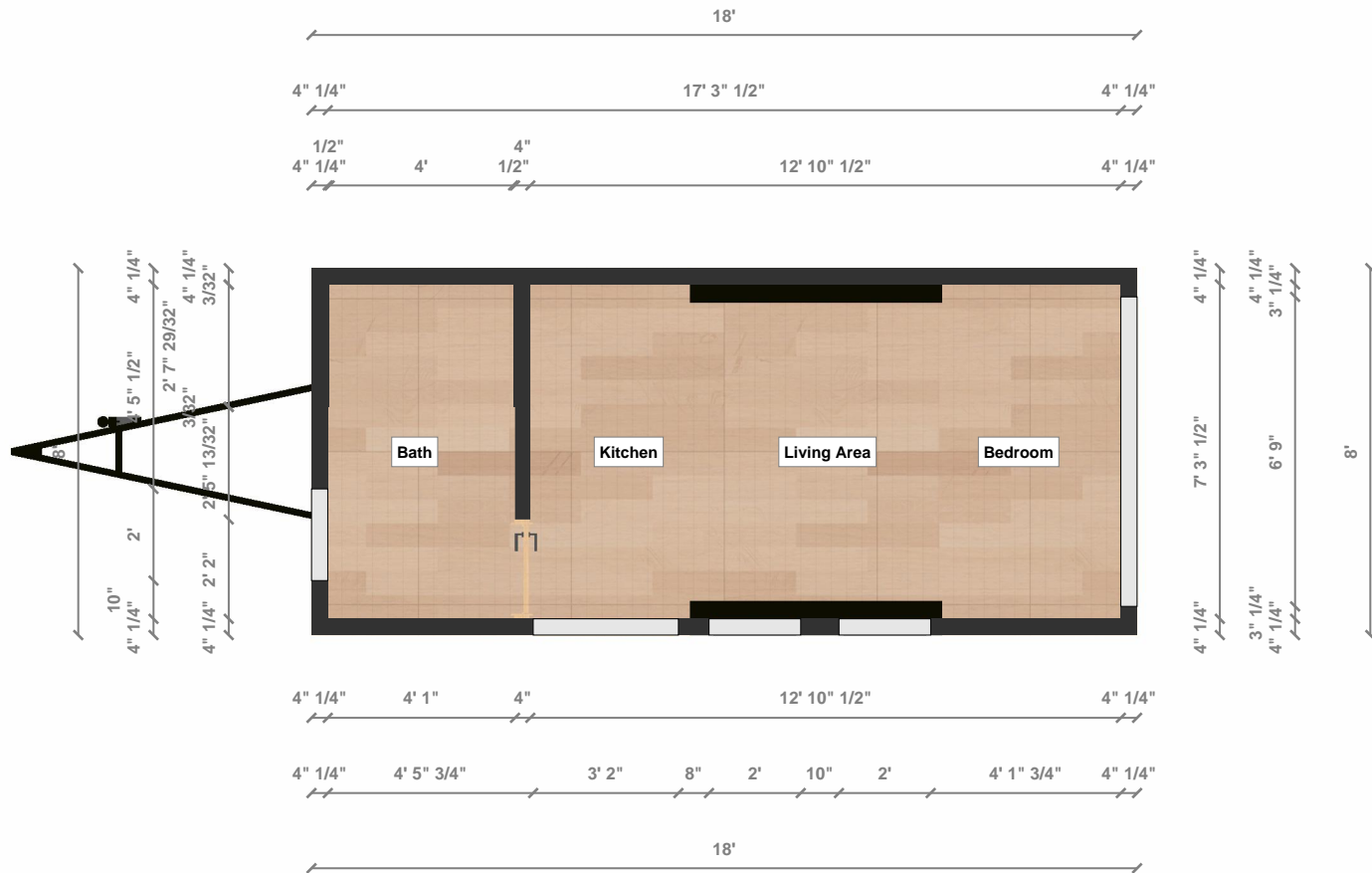

Disclaimer: © 2022 Tiny Easy LTD - This Document was automatically generated using the 3D Tiny House Designer by Tiny Easy LTD and all copyright belongs to Tiny Easy LTD. Content made available on [www.tinyeasy.co.nz](http://www.tinyeasy.co.nz) is for general information purposes only. Although all Materials have been created by a team of knowledgeable design experts and regularly undergo reviews and updates, Materials are created for a large range of users from many different countries that all have different laws and requirements for tiny homes. Accordingly, the information contained in the Materials does not constitute architectural advice, nor are they a substitute for architectural advice. Furthermore, any assistance and customer support provided by us does not establish an architect-client relationship. Tiny Easy cannot guarantee the Materials will be compliant with any applicable law in your jurisdiction. Our Materials are intended to provide ideas and inspiration, but you cannot rely on the Materials for your tiny home project you must seek advice from engineers, licensed building practitioners, and/or architects in your country. Before purchasing any Materials it is your sole responsibility to determine the legal requirements and restrictions attached to tiny homes in your country and any compliance issues that you might encounter.

Name: Nordic Overnighter

Scale: 1:50 (At A4)

System: Imperial (fr)

Plan: Shell Floor Plan



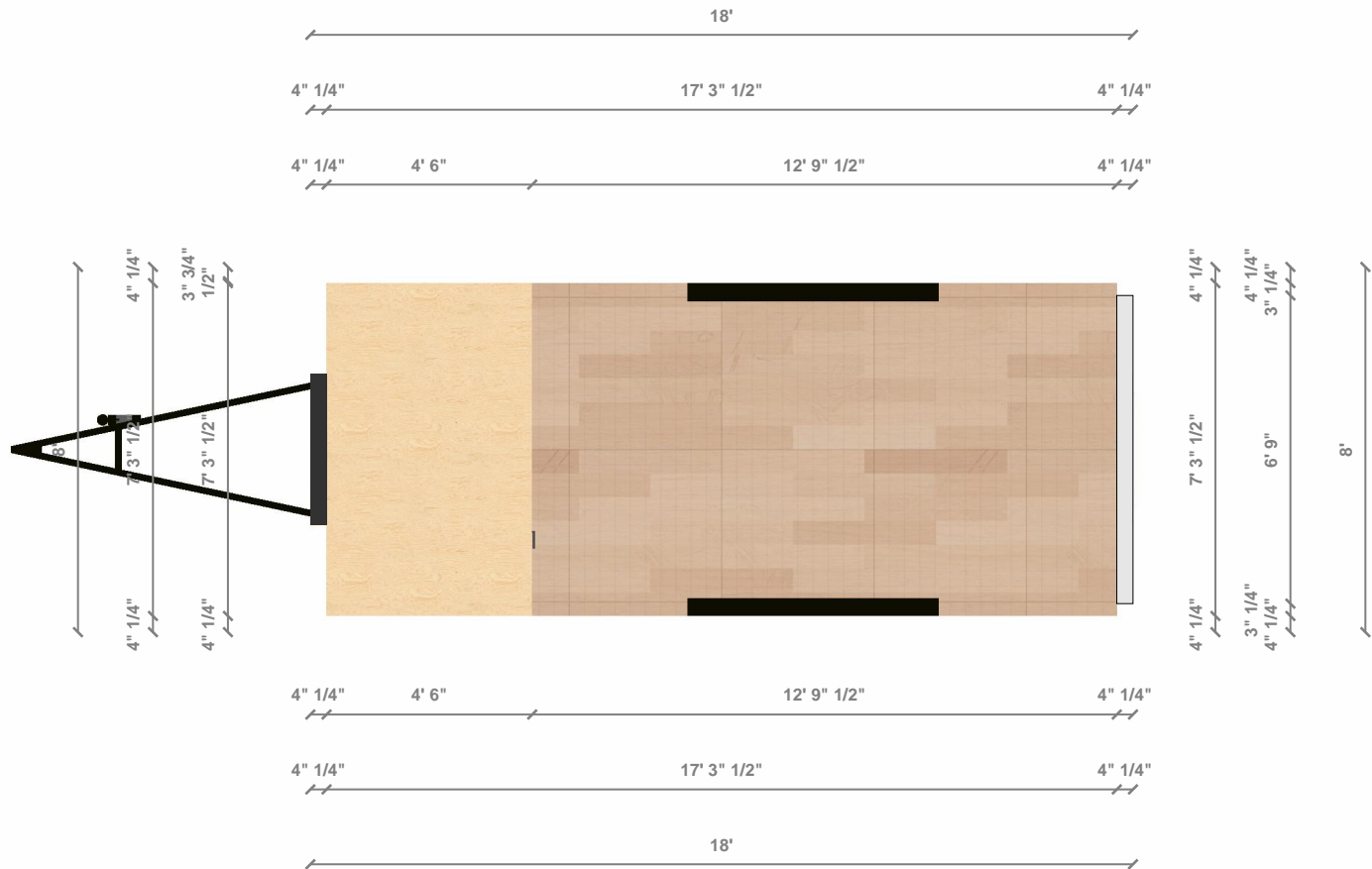

Disclaimer: © 2022 Tiny Easy LTD - This Document was automatically generated using the 3D Tiny House Designer by Tiny Easy LTD and all copyright belongs to Tiny Easy LTD. Content made available on [www.tinyeasy.co.nz](http://www.tinyeasy.co.nz) is for general information purposes only. Although all Materials have been created by a team of knowledgeable design experts and regularly undergo reviews and updates, Materials are created for a large range of users from many different countries that all have different laws and requirements for tiny homes. Accordingly, the information contained in the Materials does not constitute architectural advice, nor are they a substitute for architectural advice. Furthermore, any assistance and customer support provided by us does not establish an architect-client relationship. Tiny Easy cannot guarantee the Materials will be compliant with any applicable law in your jurisdiction. Our Materials are intended to provide ideas and inspiration, but you cannot rely on the Materials for your tiny home project you must seek advice from engineers, licensed building practitioners, and/or architects in your country. Before purchasing any Materials it is your sole responsibility to determine the legal requirements and restrictions attached to tiny homes in your country and any compliance issues that you might encounter.

Name: Nordic Overnighter  
Scale: 1:50 (At A4)  
System: Imperial (fr)  
Plan: Shell Mezzanine Plan

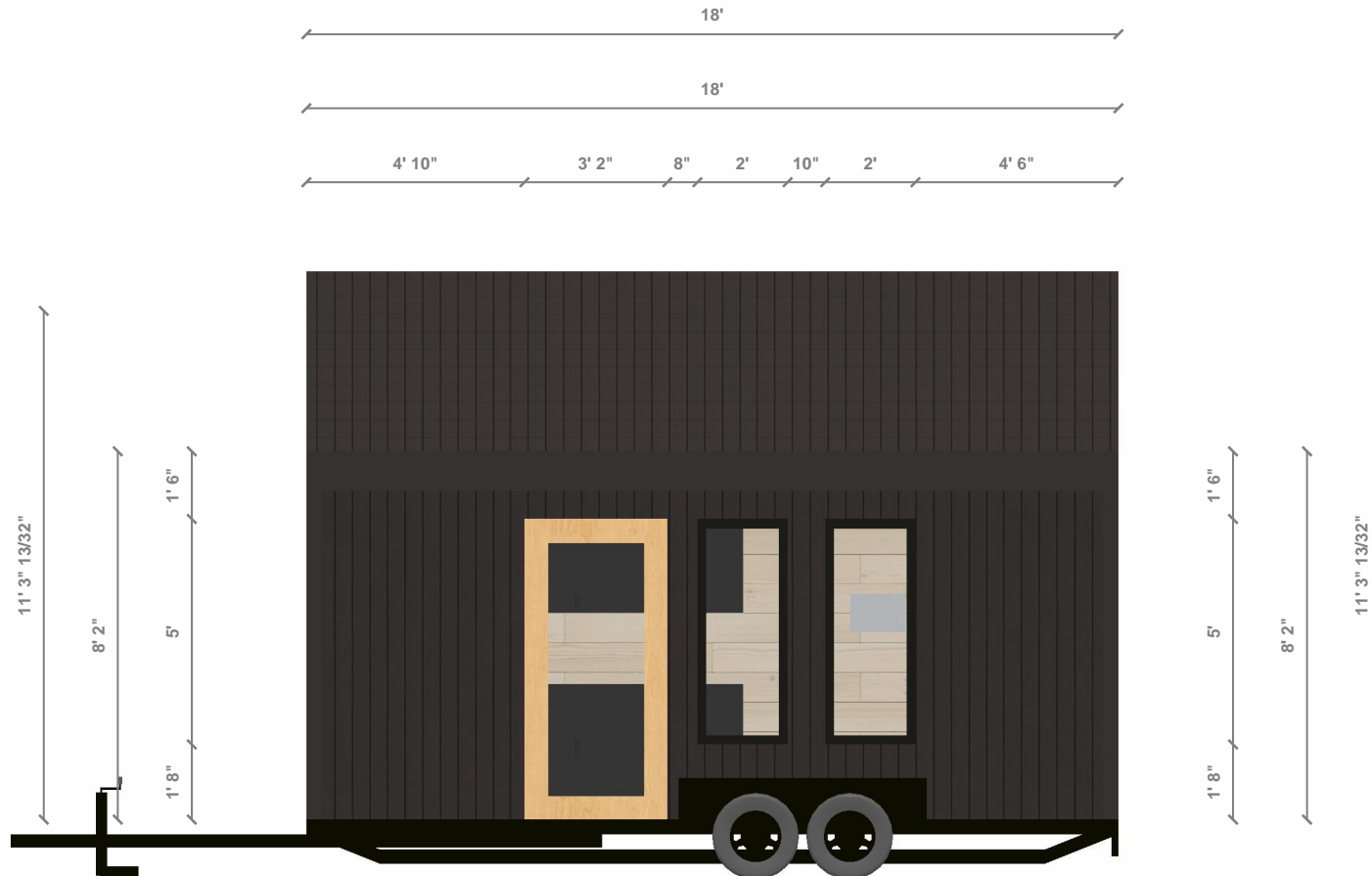

Disclaimer: © 2022 Tiny Easy LTD - This Document was automatically generated using the 3D Tiny House Designer by Tiny Easy LTD and all copyright belongs to Tiny Easy LTD. Content made available on [www.tinyeasy.co.nz](http://www.tinyeasy.co.nz) is for general information purposes only. Although all Materials have been created by a team of knowledgeable design experts and regularly undergo reviews and updates, Materials are created for a large range of users from many different countries that all have different laws and requirements for tiny homes. Accordingly, the information contained in the Materials does not constitute architectural advice, nor are they a substitute for architectural advice. Furthermore, any assistance and customer support provided by us does not establish an architect-client relationship. Tiny Easy cannot guarantee the Materials will be compliant with any applicable law in your jurisdiction. Our Materials are intended to provide ideas and inspiration, but you cannot rely on the Materials for your tiny home project you must seek advice from engineers, licensed building practitioners, and/or architects in your country. Before purchasing any Materials it is your sole responsibility to determine the legal requirements and restrictions attached to tiny homes in your country and any compliance issues that you might encounter.

Name: Nordic Overnighter

Scale: 1:50 (At A4)

System: Imperial (fr)

Plan: Left Elevation

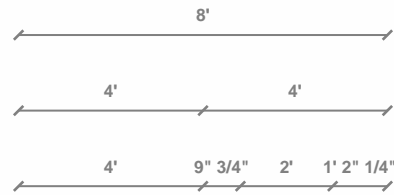

Disclaimer: © 2022 Tiny Easy LTD - This Document was automatically generated using the 3D Tiny House Designer by Tiny Easy LTD and all copyright belongs to Tiny Easy LTD. Content made available on [www.tinyeasy.co.nz](http://www.tinyeasy.co.nz) is for general information purposes only. Although all Materials have been created by a team of knowledgeable design experts and regularly undergo reviews and updates, Materials are created for a large range of users from many different countries that all have different laws and requirements for tiny homes. Accordingly, the information contained in the Materials does not constitute architectural advice, nor are they a substitute for architectural advice. Furthermore, any assistance and customer support provided by us does not establish an architect-client relationship. Tiny Easy cannot guarantee the Materials will be compliant with any applicable law in your jurisdiction. Our Materials are intended to provide ideas and inspiration, but you cannot rely on the Materials for your tiny home project you must seek advice from engineers, licensed building practitioners, and/or architects in your country. Before purchasing any Materials it is your sole responsibility to determine the legal requirements and restrictions attached to tiny homes in your country and any compliance issues that you might encounter.

Name: Nordic Overnighter

Scale: 1:50 (At A4)

System: Imperial (fr)

Plan: Front Elevation

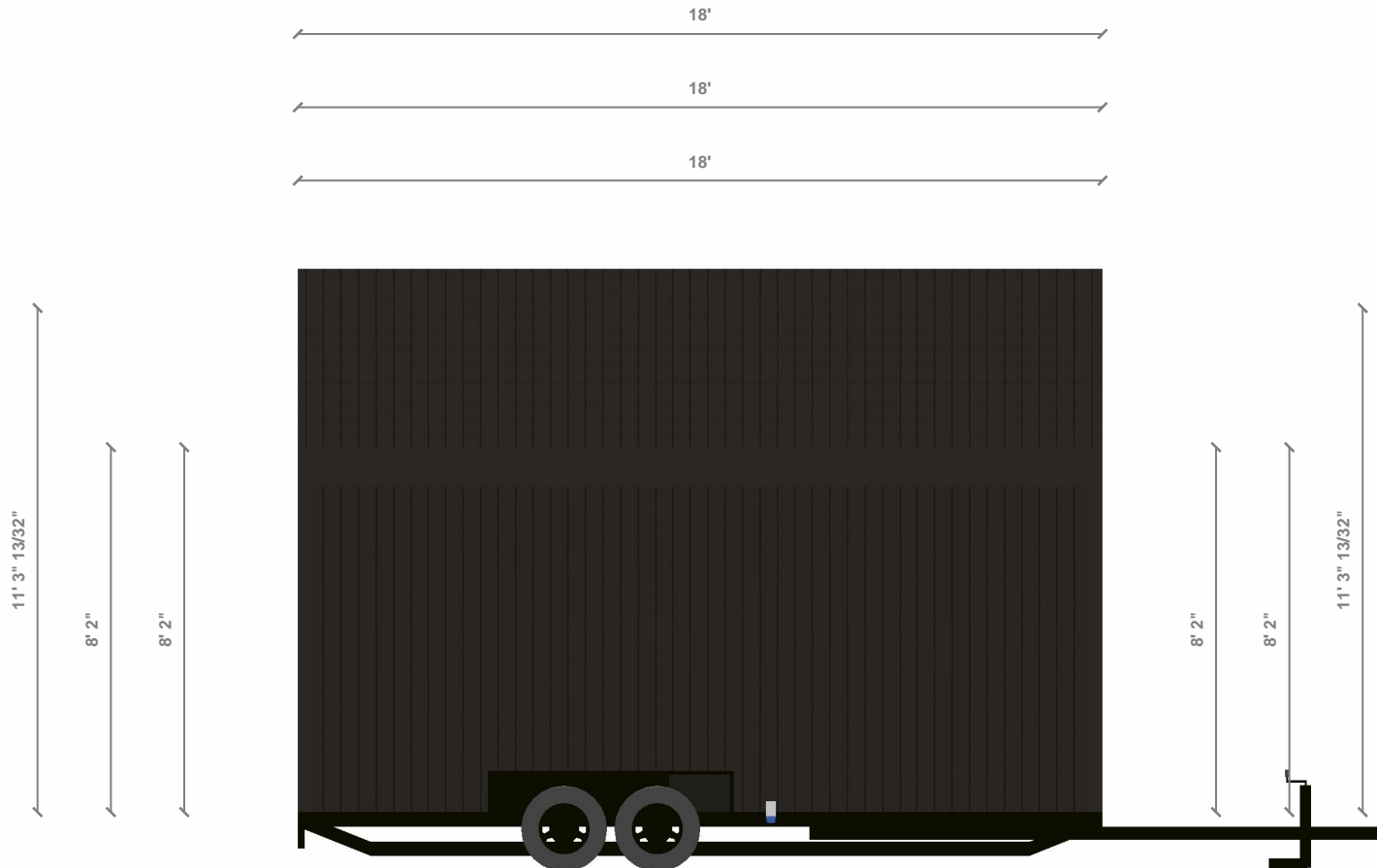

Disclaimer: © 2022 Tiny Easy LTD - This Document was automatically generated using the 3D Tiny House Designer by Tiny Easy LTD and all copyright belongs to Tiny Easy LTD. Content made available on [www.tinyeasy.co.nz](http://www.tinyeasy.co.nz) is for general information purposes only. Although all Materials have been created by a team of knowledgeable design experts and regularly undergo reviews and updates, Materials are created for a large range of users from many different countries that all have different laws and requirements for tiny homes. Accordingly, the information contained in the Materials does not constitute architectural advice, nor are they a substitute for architectural advice. Furthermore, any assistance and customer support provided by us does not establish an architect-client relationship. Tiny Easy cannot guarantee the Materials will be compliant with any applicable law in your jurisdiction. Our Materials are intended to provide ideas and inspiration, but you cannot rely on the Materials for your tiny home project you must seek advice from engineers, licensed building practitioners, and/or architects in your country. Before purchasing any Materials it is your sole responsibility to determine the legal requirements and restrictions attached to tiny homes in your country and any compliance issues that you might encounter.

Name: Nordic Overnighter

Scale: 1:50 (At A4)

System: Imperial (fr)

Plan: Right Elevation

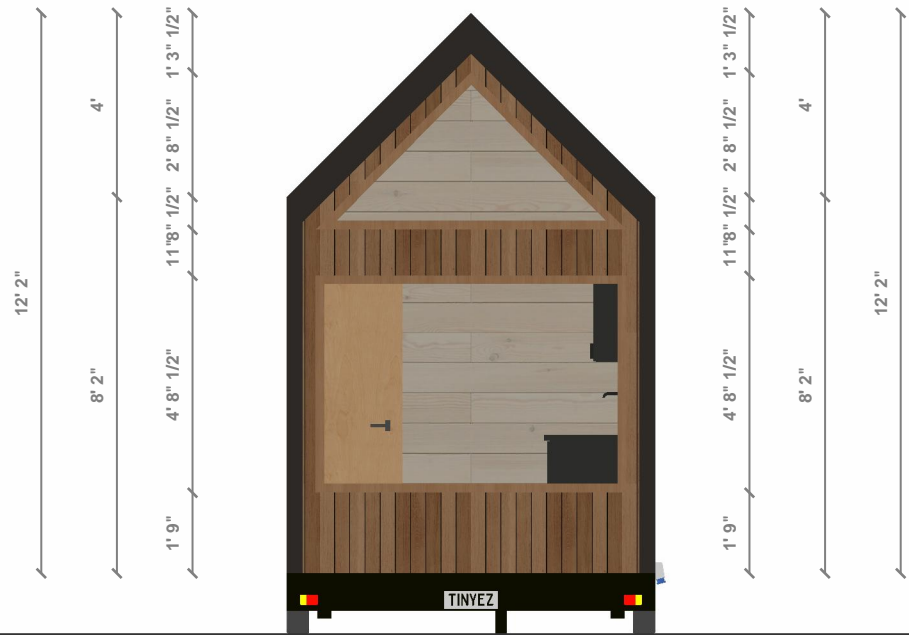
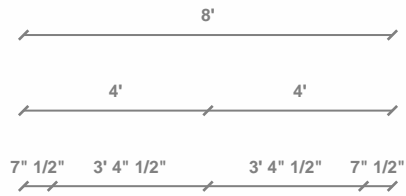

Disclaimer: © 2022 Tiny Easy LTD - This Document was automatically generated using the 3D Tiny House Designer by Tiny Easy LTD and all copyright belongs to Tiny Easy LTD. Content made available on [www.tinyeasy.co.nz](http://www.tinyeasy.co.nz) is for general information purposes only. Although all Materials have been created by a team of knowledgeable design experts and regularly undergo reviews and updates, Materials are created for a large range of users from many different countries that all have different laws and requirements for tiny homes. Accordingly, the information contained in the Materials does not constitute architectural advice, nor are they a substitute for architectural advice. Furthermore, any assistance and customer support provided by us does not establish an architect-client relationship. Tiny Easy cannot guarantee the Materials will be compliant with any applicable law in your jurisdiction. Our Materials are intended to provide ideas and inspiration, but you cannot rely on the Materials for your tiny home project you must seek advice from engineers, licensed building practitioners, and/or architects in your country. Before purchasing any Materials it is your sole responsibility to determine the legal requirements and restrictions attached to tiny homes in your country and any compliance issues that you might encounter.

Name: Nordic Overnighter

Scale: 1:50 (At A4)

System: Imperial (fr)

Plan: Rear Elevation

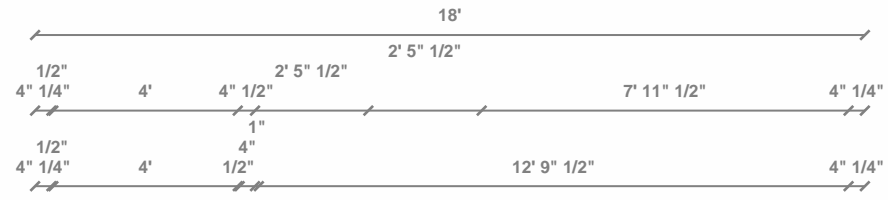

Disclaimer: © 2022 Tiny Easy LTD - This Document was automatically generated using the 3D Tiny House Designer by Tiny Easy LTD and all copyright belongs to Tiny Easy LTD. Content made available on [www.tinyeasy.co.nz](http://www.tinyeasy.co.nz) is for general information purposes only. Although all Materials have been created by a team of knowledgeable design experts and regularly undergo reviews and updates, Materials are created for a large range of users from many different countries that all have different laws and requirements for tiny homes. Accordingly, the information contained in the Materials does not constitute architectural advice, nor are they a substitute for architectural advice. Furthermore, any assistance and customer support provided by us does not establish an architect-client relationship. Tiny Easy cannot guarantee the Materials will be compliant with any applicable law in your jurisdiction. Our Materials are intended to provide ideas and inspiration, but you cannot rely on the Materials for your tiny home project you must seek advice from engineers, licensed building practitioners, and/or architects in your country. Before purchasing any Materials it is your sole responsibility to determine the legal requirements and restrictions attached to tiny homes in your country and any compliance issues that you might encounter.

Name: Nordic Overnighter  
 Scale: 1:50 (At A4)  
 System: Imperial (fr)  
 Plan: Left Section

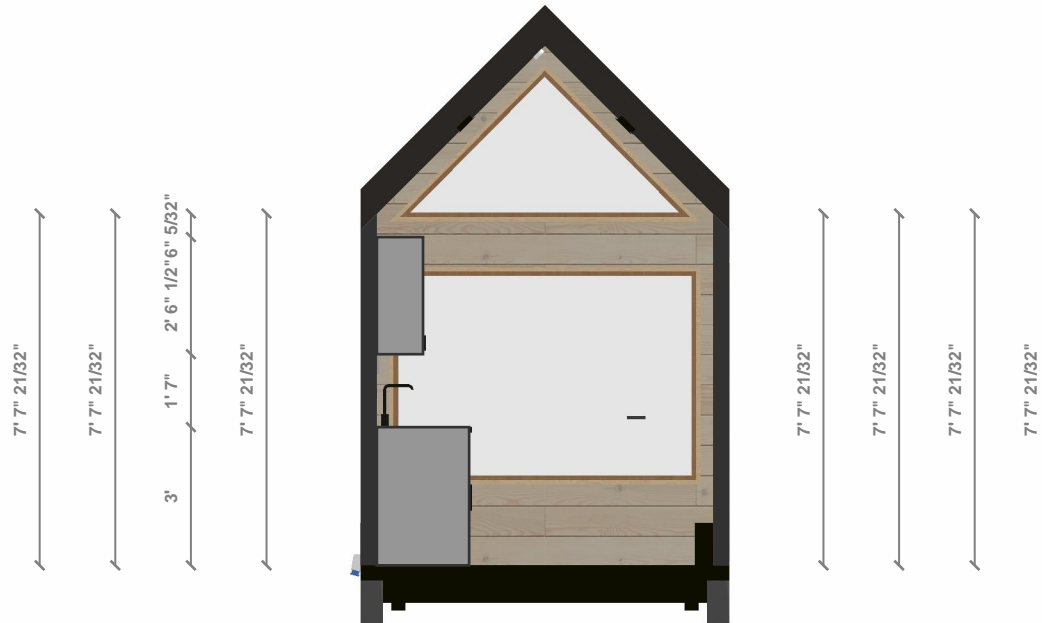
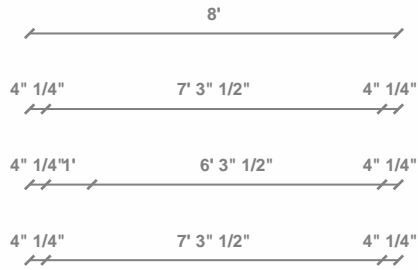

Disclaimer: © 2022 Tiny Easy LTD - This Document was automatically generated using the 3D Tiny House Designer by Tiny Easy LTD and all copyright belongs to Tiny Easy LTD. Content made available on [www.tinyeasy.co.nz](http://www.tinyeasy.co.nz) is for general information purposes only. Although all Materials have been created by a team of knowledgeable design experts and regularly undergo reviews and updates, Materials are created for a large range of users from many different countries that all have different laws and requirements for tiny homes. Accordingly, the information contained in the Materials does not constitute architectural advice, nor are they a substitute for architectural advice. Furthermore, any assistance and customer support provided by us does not establish an architect-client relationship. Tiny Easy cannot guarantee the Materials will be compliant with any applicable law in your jurisdiction. Our Materials are intended to provide ideas and inspiration, but you cannot rely on the Materials for your tiny home project you must seek advice from engineers, licensed building practitioners, and/or architects in your country. Before purchasing any Materials it is your sole responsibility to determine the legal requirements and restrictions attached to tiny homes in your country and any compliance issues that you might encounter.

Name: Nordic Overnighter

Scale: 1:50 (At A4)

System: Imperial (fr)

Plan: Front Section

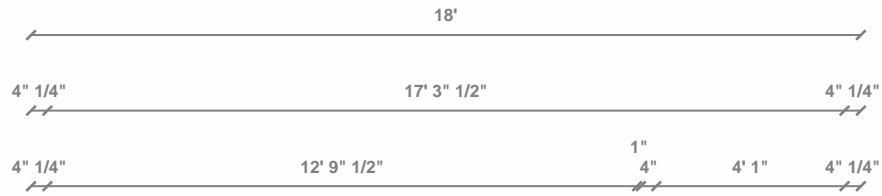

Disclaimer: © 2022 Tiny Easy LTD - This Document was automatically generated using the 3D Tiny House Designer by Tiny Easy LTD and all copyright belongs to Tiny Easy LTD. Content made available on [www.tinyeasy.co.nz](http://www.tinyeasy.co.nz) is for general information purposes only. Although all Materials have been created by a team of knowledgeable design experts and regularly undergo reviews and updates, Materials are created for a large range of users from many different countries that all have different laws and requirements for tiny homes. Accordingly, the information contained in the Materials does not constitute architectural advice, nor are they a substitute for architectural advice. Furthermore, any assistance and customer support provided by us does not establish an architect-client relationship. Tiny Easy cannot guarantee the Materials will be compliant with any applicable law in your jurisdiction. Our Materials are intended to provide ideas and inspiration, but you cannot rely on the Materials for your tiny home project you must seek advice from engineers, licensed building practitioners, and/or architects in your country. Before purchasing any Materials it is your sole responsibility to determine the legal requirements and restrictions attached to tiny homes in your country and any compliance issues that you might encounter.

Name: Nordic Overnighter

Scale: 1:50 (At A4)

System: Imperial (fr)

Plan: Right Section



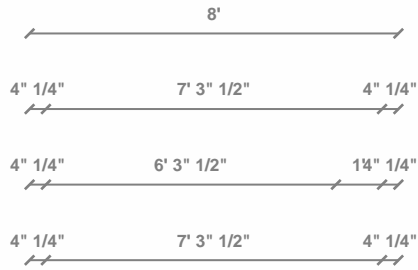

Disclaimer: © 2022 Tiny Easy LTD - This Document was automatically generated using the 3D Tiny House Designer by Tiny Easy LTD and all copyright belongs to Tiny Easy LTD. Content made available on [www.tinyeasy.co.nz](http://www.tinyeasy.co.nz) is for general information purposes only. Although all Materials have been created by a team of knowledgeable design experts and regularly undergo reviews and updates, Materials are created for a large range of users from many different countries that all have different laws and requirements for tiny homes. Accordingly, the information contained in the Materials does not constitute architectural advice, nor are they a substitute for architectural advice. Furthermore, any assistance and customer support provided by us does not establish an architect-client relationship. Tiny Easy cannot guarantee the Materials will be compliant with any applicable law in your jurisdiction. Our Materials are intended to provide ideas and inspiration, but you cannot rely on the Materials for your tiny home project you must seek advice from engineers, licensed building practitioners, and/or architects in your country. Before purchasing any Materials it is your sole responsibility to determine the legal requirements and restrictions attached to tiny homes in your country and any compliance issues that you might encounter.

Name: Nordic Overnighter

Scale: 1:50 (At A4)

System: Imperial (fr)

Plan: Rear Section



Disclaimer: © 2022 Tiny Easy LTD - This Document was automatically generated using the 3D Tiny House Designer by Tiny Easy LTD and all copyright belongs to Tiny Easy LTD. Content made available on [www.tinyeasy.co.nz](http://www.tinyeasy.co.nz) is for general information purposes only. Although all Materials have been created by a team of knowledgeable design experts and regularly undergo reviews and updates, Materials are created for a large range of users from many different countries that all have different laws and requirements for tiny homes. Accordingly, the information contained in the Materials does not constitute architectural advice, nor are they a substitute for architectural advice. Furthermore, any assistance and customer support provided by us does not establish an architect-client relationship. Tiny Easy cannot guarantee the Materials will be compliant with any applicable law in your jurisdiction. Our Materials are intended to provide ideas and inspiration, but you cannot rely on the Materials for your tiny home project you must seek advice from engineers, licensed building practitioners, and/or architects in your country. Before purchasing any Materials it is your sole responsibility to determine the legal requirements and restrictions attached to tiny homes in your country and any compliance issues that you might encounter.

Name: Nordic Overnighter

Scale: 1:50 (At A4)

System: Imperial (fr)

Plan: Shell Left Section

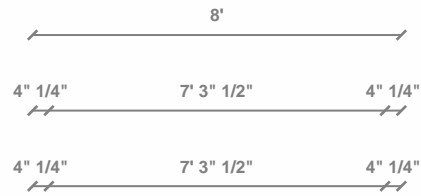

Disclaimer: © 2022 Tiny Easy LTD - This Document was automatically generated using the 3D Tiny House Designer by Tiny Easy LTD and all copyright belongs to Tiny Easy LTD. Content made available on [www.tinyeasy.co.nz](http://www.tinyeasy.co.nz) is for general information purposes only. Although all Materials have been created by a team of knowledgeable design experts and regularly undergo reviews and updates, Materials are created for a large range of users from many different countries that all have different laws and requirements for tiny homes. Accordingly, the information contained in the Materials does not constitute architectural advice, nor are they a substitute for architectural advice. Furthermore, any assistance and customer support provided by us does not establish an architect-client relationship. Tiny Easy cannot guarantee the Materials will be compliant with any applicable law in your jurisdiction. Our Materials are intended to provide ideas and inspiration, but you cannot rely on the Materials for your tiny home project you must seek advice from engineers, licensed building practitioners, and/or architects in your country. Before purchasing any Materials it is your sole responsibility to determine the legal requirements and restrictions attached to tiny homes in your country and any compliance issues that you might encounter.

Name: Nordic Overnighter

Scale: 1:50 (At A4)

System: Imperial (fr)

Plan: Shell Front Section



Disclaimer: © 2022 Tiny Easy LTD - This Document was automatically generated using the 3D Tiny House Designer by Tiny Easy LTD and all copyright belongs to Tiny Easy LTD. Content made available on [www.tinyeasy.co.nz](http://www.tinyeasy.co.nz) is for general information purposes only. Although all Materials have been created by a team of knowledgeable design experts and regularly undergo reviews and updates, Materials are created for a large range of users from many different countries that all have different laws and requirements for tiny homes. Accordingly, the information contained in the Materials does not constitute architectural advice, nor are they a substitute for architectural advice. Furthermore, any assistance and customer support provided by us does not establish an architect-client relationship. Tiny Easy cannot guarantee the Materials will be compliant with any applicable law in your jurisdiction. Our Materials are intended to provide ideas and inspiration, but you cannot rely on the Materials for your tiny home project you must seek advice from engineers, licensed building practitioners, and/or architects in your country. Before purchasing any Materials it is your sole responsibility to determine the legal requirements and restrictions attached to tiny homes in your country and any compliance issues that you might encounter.

Name: Nordic Overnighter

Scale: 1:50 (At A4)

System: Imperial (fr)

Plan: Shell Right Section

19

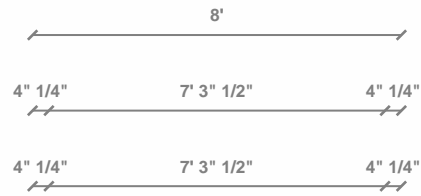

Disclaimer: © 2022 Tiny Easy LTD - This Document was automatically generated using the 3D Tiny House Designer by Tiny Easy LTD and all copyright belongs to Tiny Easy LTD. Content made available on [www.tinyeasy.co.nz](http://www.tinyeasy.co.nz) is for general information purposes only. Although all Materials have been created by a team of knowledgeable design experts and regularly undergo reviews and updates, Materials are created for a large range of users from many different countries that all have different laws and requirements for tiny homes. Accordingly, the information contained in the Materials does not constitute architectural advice, nor are they a substitute for architectural advice. Furthermore, any assistance and customer support provided by us does not establish an architect-client relationship. Tiny Easy cannot guarantee the Materials will be compliant with any applicable law in your jurisdiction. Our Materials are intended to provide ideas and inspiration, but you cannot rely on the Materials for your tiny home project you must seek advice from engineers, licensed building practitioners, and/or architects in your country. Before purchasing any Materials it is your sole responsibility to determine the legal requirements and restrictions attached to tiny homes in your country and any compliance issues that you might encounter.

Name: Nordic Overnighter

Scale: 1:50 (At A4)

System: Imperial (fr)

Plan: Shell Rear Section

ID	Width x Height (fr)	Panel Count	Opening	Glazing Amount	Jamb Finish	Glass Finish	Frame Color	Wall Thickness (fr)	Window U-Value	Window Brand	Egress Window	Notes	Re-Use Existing
Exterior Doors													
1	3' 2" X 6' 8"	1	Left	Double	Unfinished	Clear	Wood	4" 1/2"	.32		no	Tempered Glass	no
Windows													
1	2' X 5'	1	Fixed	Double	Unfinished	UvCoated		4" 1/2"	.32	Custom	no	Tempered	no
2	2' X 5'	1	Left	Double	Unfinished	UvCoated		4" 1/2"	.19	Jeld-Wen	no	Annealed	no
3	2' X 5'	1	Left	Double	Unfinished	UvCoated	Black	4" 1/2"	.19	Jeld-Wen	yes	Annealed	no
4	6' 9" X 4' 8" 1/2"	1	Fixed	Double	Unfinished	UvCoated		4" 1/2"	.29	Custom	no	Frameless Tempered	no
5	6' 9" X 3' 5"	1	Fixed	Double	Unfinished	UvCoated		4" 1/2"	.29	Custom	no	Tempered Fixed	no

Skylights



Disclaimer: © 2022 Tiny Easy LTD - This Document was automatically generated using the 3D Tiny House Designer by Tiny Easy LTD and all copyright belongs to Tiny Easy LTD. Content made available on www.tinyeasy.co.nz is for general information purposes only. Although all Materials have been created by a team of knowledgeable design experts and regularly undergo reviews and updates, Materials are created for a large range of users from many different countries that all have different laws and requirements for tiny homes. Accordingly, the information contained in the Materials does not constitute architectural advice, nor are they a substitute for architectural advice. Furthermore, any assistance and customer support provided by us does not establish an architect-client relationship. Tiny Easy cannot guarantee the Materials will be compliant with any applicable law in your jurisdiction. Our Materials are intended to provide ideas and inspiration, but you cannot rely on the Materials for your tiny home project you must seek advice from engineers, licensed building practitioners, and/or architects in your country. Before purchasing any Materials it is your sole responsibility to determine the legal requirements and restrictions attached to tiny homes in your country and any compliance issues that you might encounter.

Name: Nordic Overnighter  
 Scale: 1:- (At A4)  
 System: Imperial (fr)  
 Plan: Joinery Schedule

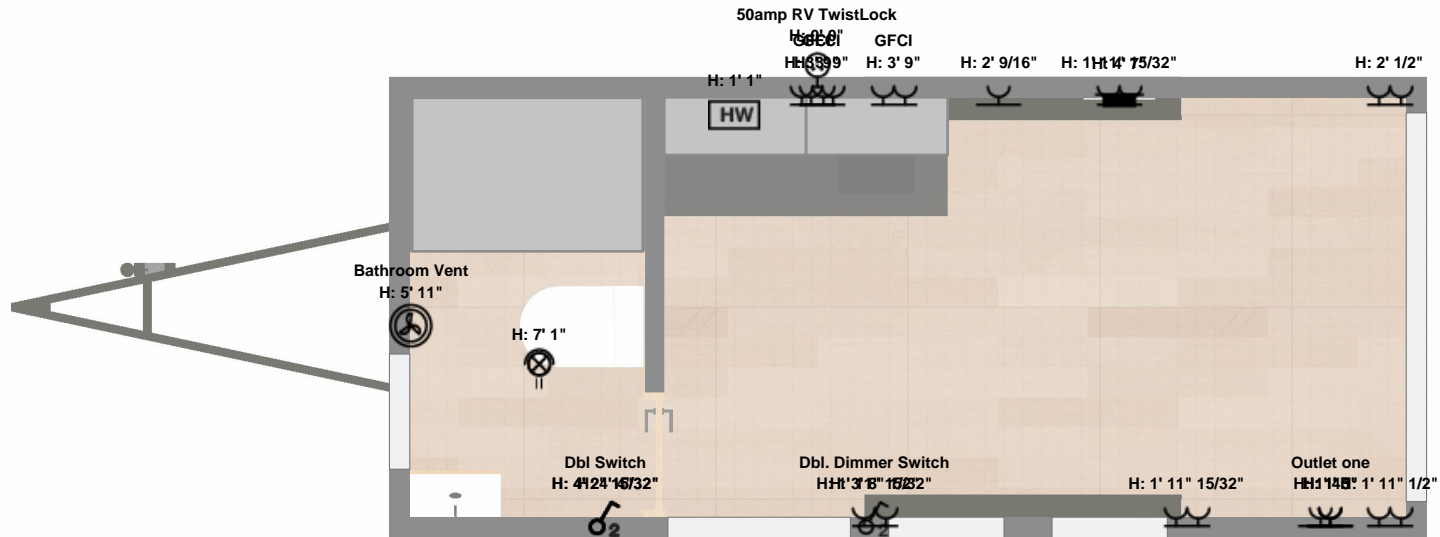

Icon	Item Name	No.	Icon	Item Name	No.	Icon	Item Name	No.	Icon	Item Name	No.	Icon	Item Name	No.
	SingleSwitch	0		DoubleOutlet	8		ExteriorOutlet	0		RailLight	0		CaravanPlug	1
	DoubleSwitch	4		UsbOutlet	0		DownLight	6		OutdoorLight	0		MainPowerIn	0
	TripleSwitch	0		TvOutlet	0		PendantLight	0		ThroughWallFan	1		SwitchBoard	1
	QuadSwitch	0		Brushplate	0		WallMountedLight	0		Heatpump	0		SmokeDetector	1
	DimmerSwitch	0		EthernetOutlet	0		MirrorLight	0		SmartController	0		CarbonMonoxideDet	0
	SingleOutlet	4		HdmiOutlet	0		StripLight	0		HotWaterHeater	1		Other	0

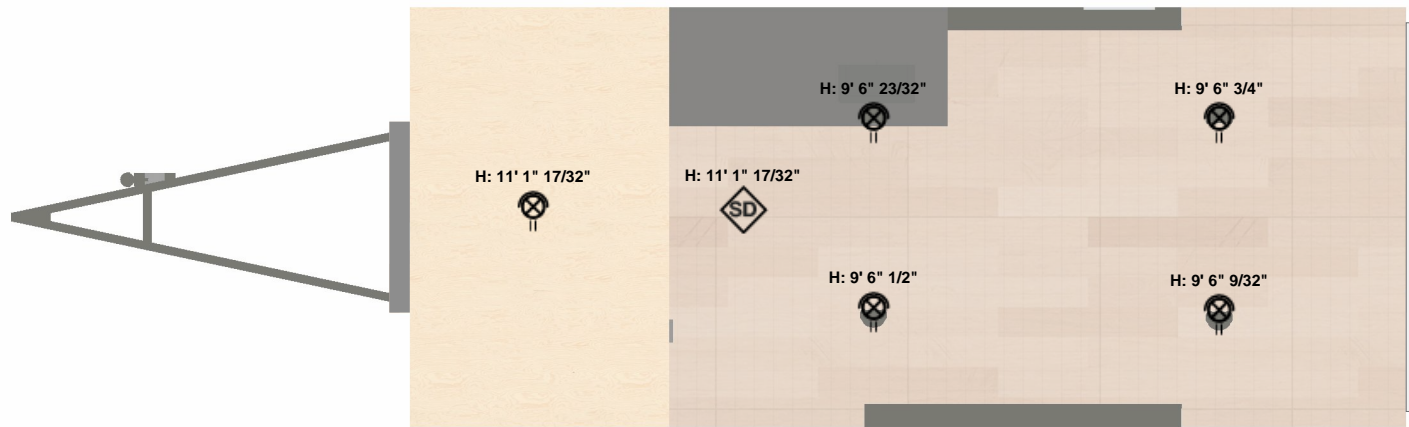

Icon	Item Name	No.	Icon	Item Name	No.	Icon	Item Name	No.	Icon	Item Name	No.	Icon	Item Name	No.
	SingleSwitch	0		DoubleOutlet	8		ExteriorOutlet	0		RailLight	0		CaravanPlug	1
	DoubleSwitch	4		UsbOutlet	0		DownLight	6		OutdoorLight	0		MainPowerIn	0
	TripleSwitch	0		TvOutlet	0		PendantLight	0		ThroughWallFan	1		SwitchBoard	1
	QuadSwitch	0		Brushplate	0		WallMountedLight	0		Heatpump	0		SmokeDetector	1
	DimmerSwitch	0		EthernetOutlet	0		MirrorLight	0		SmartController	0		CarbonMonoxideDet	0
	SingleOutlet	4		HdmiOutlet	0		StripLight	0		HotWaterHeater	1		Other	0



Unique Name	Notes	Unique Name	Notes	Unique Name	Notes
DbI Switch	Bathroom Light and fan				

--	--	--	--	--	--



Disclaimer: © 2022 Tiny Easy LTD - This Document was automatically generated using the 3D Tiny House Designer by Tiny Easy LTD and all copyright belongs to Tiny Easy LTD. Content made available on [www.tinyeasy.co.nz](http://www.tinyeasy.co.nz) is for general information purposes only. Although all Materials have been created by a team of knowledgeable design experts and regularly undergo reviews and updates, Materials are created for a large range of users from many different countries that all have different laws and requirements for tiny homes. Accordingly, the information contained in the Materials does not constitute architectural advice, nor are they a substitute for architectural advice. Furthermore, any assistance and customer support provided by us does not establish an architect-client relationship. Tiny Easy cannot guarantee the Materials will be compliant with any applicable law in your jurisdiction. Our Materials are intended to provide ideas and inspiration, but you cannot rely on the Materials for your tiny home project you must seek advice from engineers, licensed building practitioners, and/or architects in your country. Before purchasing any Materials it is your sole responsibility to determine the legal requirements and restrictions attached to tiny homes in your country and any compliance issues that you might encounter.

Name: Nordic Overnighter

Scale: 1:- (At A4)

System: Imperial (fr)

Plan: Electrical Components Notes

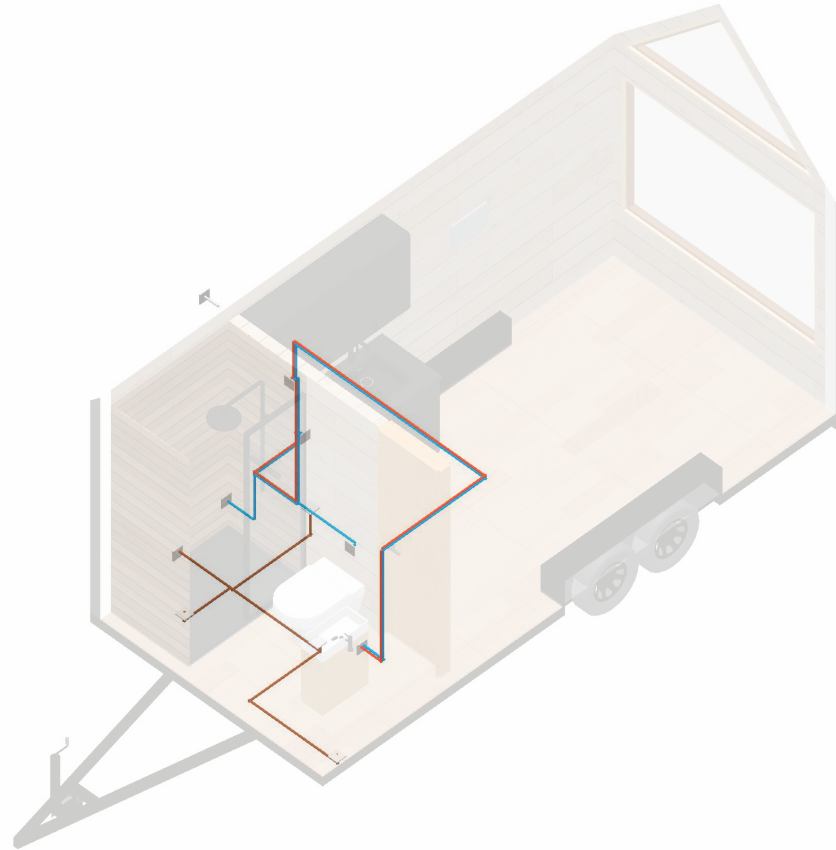

Disclaimer: © 2022 Tiny Easy LTD - This Document was automatically generated using the 3D Tiny House Designer by Tiny Easy LTD and all copyright belongs to Tiny Easy LTD. Content made available on [www.tinyeasy.co.nz](http://www.tinyeasy.co.nz) is for general information purposes only. Although all Materials have been created by a team of knowledgeable design experts and regularly undergo reviews and updates, Materials are created for a large range of users from many different countries that all have different laws and requirements for tiny homes. Accordingly, the information contained in the Materials does not constitute architectural advice, nor are they a substitute for architectural advice. Furthermore, any assistance and customer support provided by us does not establish an architect-client relationship. Tiny Easy cannot guarantee the Materials will be compliant with any applicable law in your jurisdiction. Our Materials are intended to provide ideas and inspiration, but you cannot rely on the Materials for your tiny home project you must seek advice from engineers, licensed building practitioners, and/or architects in your country. Before purchasing any Materials it is your sole responsibility to determine the legal requirements and restrictions attached to tiny homes in your country and any compliance issues that you might encounter.

Name: Nordic Overnighter

Scale: 1:50 (At A4)

System: Imperial (fr)

Plan: Front Left Plumbing

25

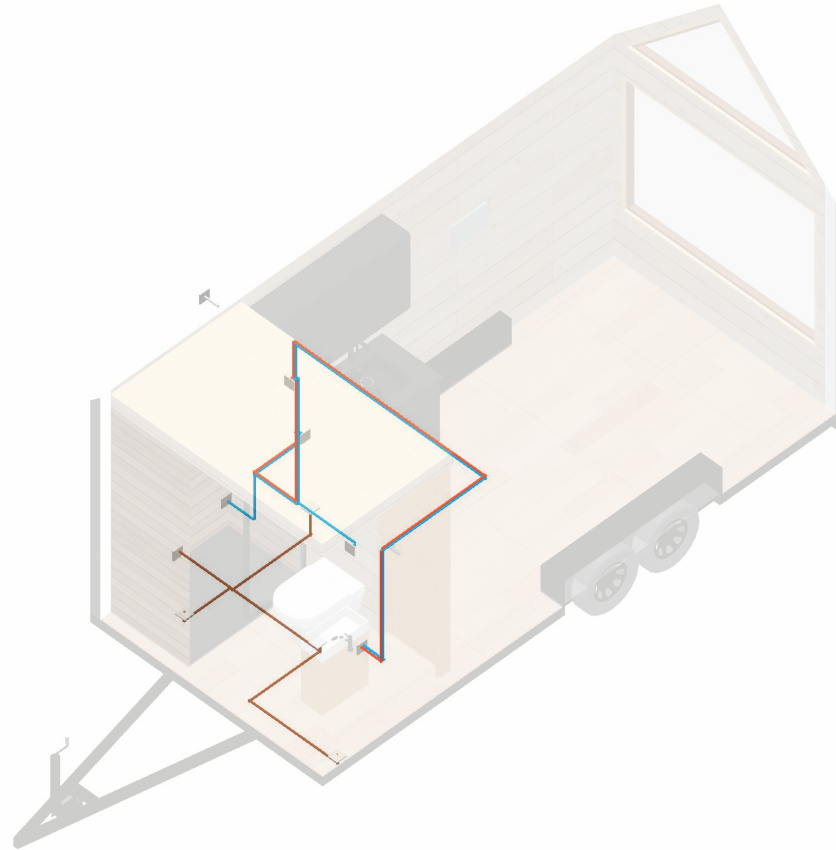

Disclaimer: © 2022 Tiny Easy LTD - This Document was automatically generated using the 3D Tiny House Designer by Tiny Easy LTD and all copyright belongs to Tiny Easy LTD. Content made available on [www.tinyeasy.co.nz](http://www.tinyeasy.co.nz) is for general information purposes only. Although all Materials have been created by a team of knowledgeable design experts and regularly undergo reviews and updates, Materials are created for a large range of users from many different countries that all have different laws and requirements for tiny homes. Accordingly, the information contained in the Materials does not constitute architectural advice, nor are they a substitute for architectural advice. Furthermore, any assistance and customer support provided by us does not establish an architect-client relationship. Tiny Easy cannot guarantee the Materials will be compliant with any applicable law in your jurisdiction. Our Materials are intended to provide ideas and inspiration, but you cannot rely on the Materials for your tiny home project you must seek advice from engineers, licensed building practitioners, and/or architects in your country. Before purchasing any Materials it is your sole responsibility to determine the legal requirements and restrictions attached to tiny homes in your country and any compliance issues that you might encounter.

Name: Nordic Overnighter

Scale: 1:50 (At A4)

System: Imperial (fr)

Plan: Front Left w Loft Plumbing

26

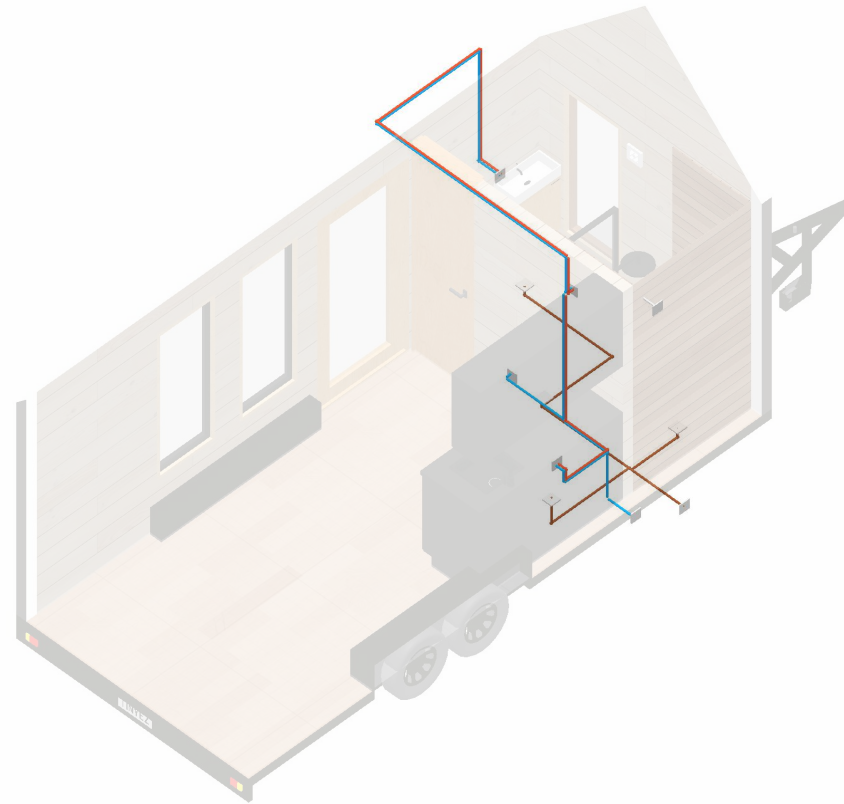

Disclaimer: © 2022 Tiny Easy LTD - This Document was automatically generated using the 3D Tiny House Designer by Tiny Easy LTD and all copyright belongs to Tiny Easy LTD. Content made available on [www.tinyeasy.co.nz](http://www.tinyeasy.co.nz) is for general information purposes only. Although all Materials have been created by a team of knowledgeable design experts and regularly undergo reviews and updates, Materials are created for a large range of users from many different countries that all have different laws and requirements for tiny homes. Accordingly, the information contained in the Materials does not constitute architectural advice, nor are they a substitute for architectural advice. Furthermore, any assistance and customer support provided by us does not establish an architect-client relationship. Tiny Easy cannot guarantee the Materials will be compliant with any applicable law in your jurisdiction. Our Materials are intended to provide ideas and inspiration, but you cannot rely on the Materials for your tiny home project you must seek advice from engineers, licensed building practitioners, and/or architects in your country. Before purchasing any Materials it is your sole responsibility to determine the legal requirements and restrictions attached to tiny homes in your country and any compliance issues that you might encounter.

Name: Nordic Overnighter

Scale: 1:50 (At A4)

System: Imperial (fr)

Plan: Rear Right Plumbing

27

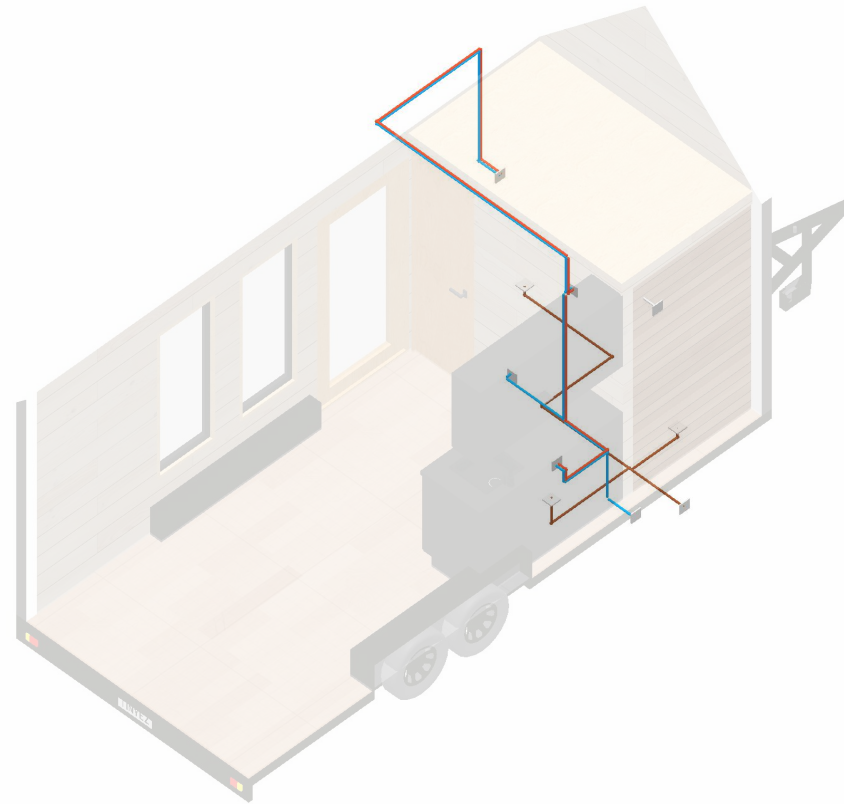

Disclaimer: © 2022 Tiny Easy LTD - This Document was automatically generated using the 3D Tiny House Designer by Tiny Easy LTD and all copyright belongs to Tiny Easy LTD. Content made available on [www.tinyeasy.co.nz](http://www.tinyeasy.co.nz) is for general information purposes only. Although all Materials have been created by a team of knowledgeable design experts and regularly undergo reviews and updates, Materials are created for a large range of users from many different countries that all have different laws and requirements for tiny homes. Accordingly, the information contained in the Materials does not constitute architectural advice, nor are they a substitute for architectural advice. Furthermore, any assistance and customer support provided by us does not establish an architect-client relationship. Tiny Easy cannot guarantee the Materials will be compliant with any applicable law in your jurisdiction. Our Materials are intended to provide ideas and inspiration, but you cannot rely on the Materials for your tiny home project you must seek advice from engineers, licensed building practitioners, and/or architects in your country. Before purchasing any Materials it is your sole responsibility to determine the legal requirements and restrictions attached to tiny homes in your country and any compliance issues that you might encounter.

Name: Nordic Overnighter

Scale: 1:50 (At A4)

System: Imperial (fr)

Plan: Rear Right Plumbing

28

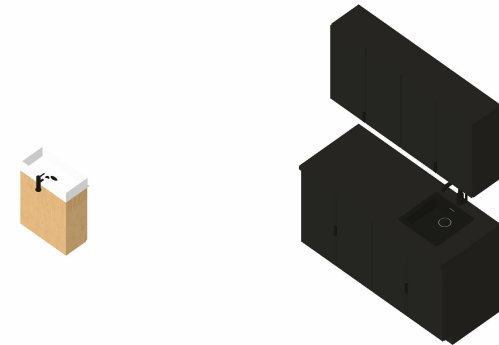
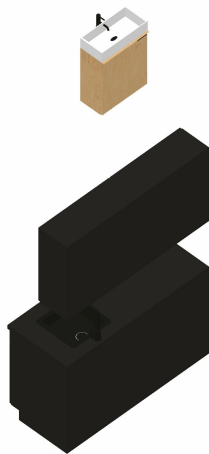
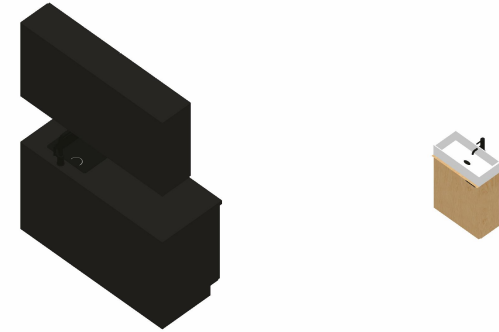
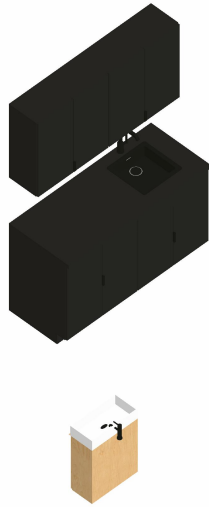

Disclaimer: © 2022 Tiny Easy LTD - This Document was automatically generated using the 3D Tiny House Designer by Tiny Easy LTD and all copyright belongs to Tiny Easy LTD. Content made available on [www.tinyeasy.co.nz](http://www.tinyeasy.co.nz) is for general information purposes only. Although all Materials have been created by a team of knowledgeable design experts and regularly undergo reviews and updates, Materials are created for a large range of users from many different countries that all have different laws and requirements for tiny homes. Accordingly, the information contained in the Materials does not constitute architectural advice, nor are they a substitute for architectural advice. Furthermore, any assistance and customer support provided by us does not establish an architect-client relationship. Tiny Easy cannot guarantee the Materials will be compliant with any applicable law in your jurisdiction. Our Materials are intended to provide ideas and inspiration, but you cannot rely on the Materials for your tiny home project you must seek advice from engineers, licensed building practitioners, and/or architects in your country. Before purchasing any Materials it is your sole responsibility to determine the legal requirements and restrictions attached to tiny homes in your country and any compliance issues that you might encounter.

Name: Nordic Overnighter

Scale: 1:50 (At A4)

System: Imperial (fr)

Plan: Cabinet Isometrics

29

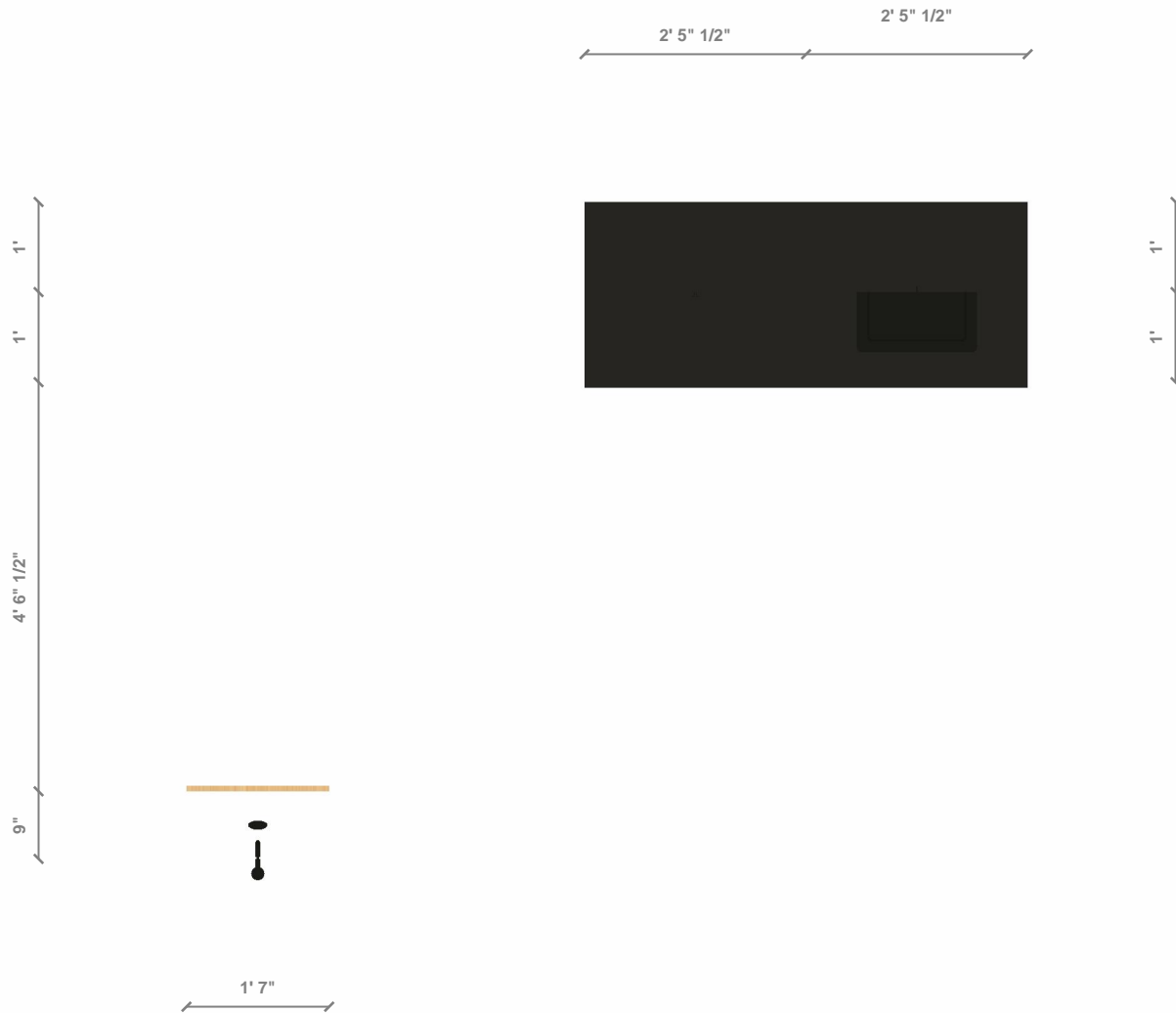

Disclaimer: © 2022 Tiny Easy LTD - This Document was automatically generated using the 3D Tiny House Designer by Tiny Easy LTD and all copyright belongs to Tiny Easy LTD. Content made available on [www.tinyeasy.co.nz](http://www.tinyeasy.co.nz) is for general information purposes only. Although all Materials have been created by a team of knowledgeable design experts and regularly undergo reviews and updates, Materials are created for a large range of users from many different countries that all have different laws and requirements for tiny homes. Accordingly, the information contained in the Materials does not constitute architectural advice, nor are they a substitute for architectural advice. Furthermore, any assistance and customer support provided by us does not establish an architect-client relationship. Tiny Easy cannot guarantee the Materials will be compliant with any applicable law in your jurisdiction. Our Materials are intended to provide ideas and inspiration, but you cannot rely on the Materials for your tiny home project you must seek advice from engineers, licensed building practitioners, and/or architects in your country. Before purchasing any Materials it is your sole responsibility to determine the legal requirements and restrictions attached to tiny homes in your country and any compliance issues that you might encounter.

Name: Nordic Overnighter

Scale: 1:25 (At A4)

System: Imperial (fr)

Plan: Cabinet Plan

30

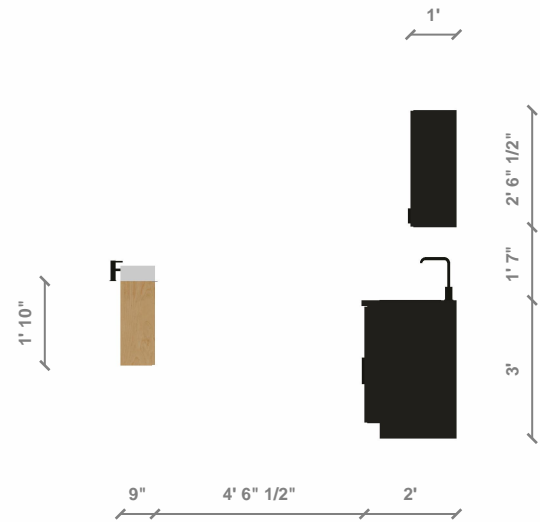
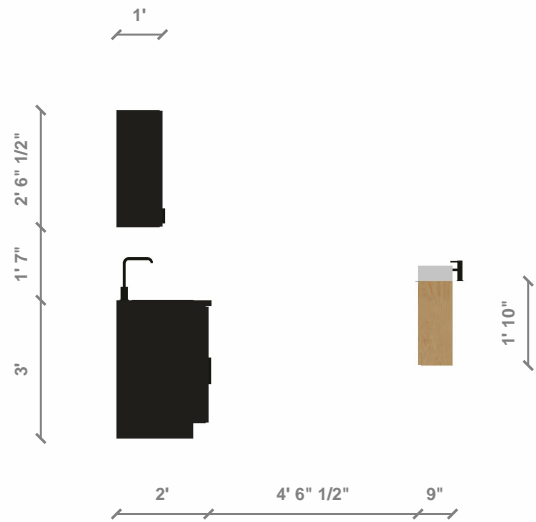
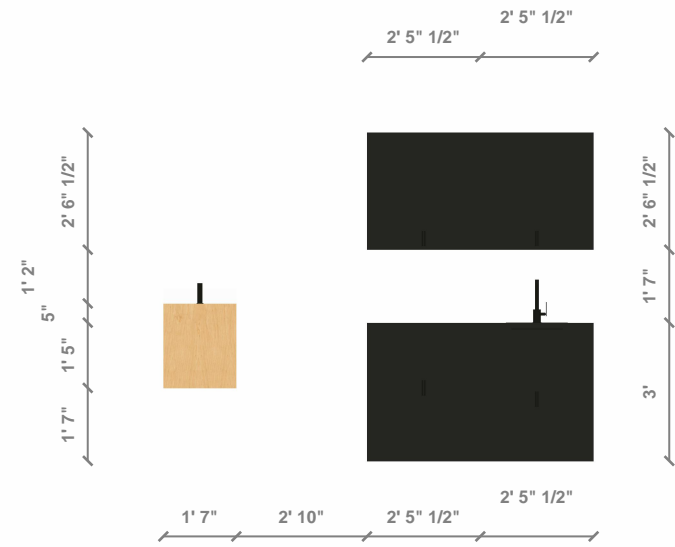
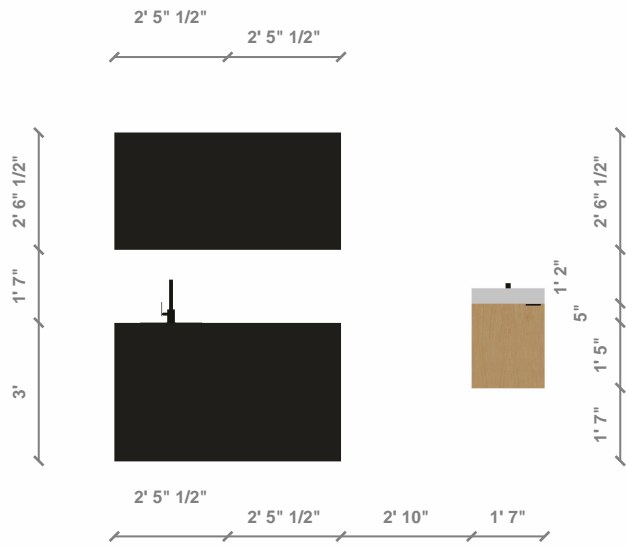

Disclaimer: © 2022 Tiny Easy LTD - This Document was automatically generated using the 3D Tiny House Designer by Tiny Easy LTD and all copyright belongs to Tiny Easy LTD. Content made available on [www.tinyeasy.co.nz](http://www.tinyeasy.co.nz) is for general information purposes only. Although all Materials have been created by a team of knowledgeable design experts and regularly undergo reviews and updates, Materials are created for a large range of users from many different countries that all have different laws and requirements for tiny homes. Accordingly, the information contained in the Materials does not constitute architectural advice, nor are they a substitute for architectural advice. Furthermore, any assistance and customer support provided by us does not establish an architect-client relationship. Tiny Easy cannot guarantee the Materials will be compliant with any applicable law in your jurisdiction. Our Materials are intended to provide ideas and inspiration, but you cannot rely on the Materials for your tiny home project you must seek advice from engineers, licensed building practitioners, and/or architects in your country. Before purchasing any Materials it is your sole responsibility to determine the legal requirements and restrictions attached to tiny homes in your country and any compliance issues that you might encounter.

Name: Nordic Overnighter

Scale: 1:25 (At A4)

System: Imperial (fr)

Plan: Cabinet Elevations